

GSD

125-103-5

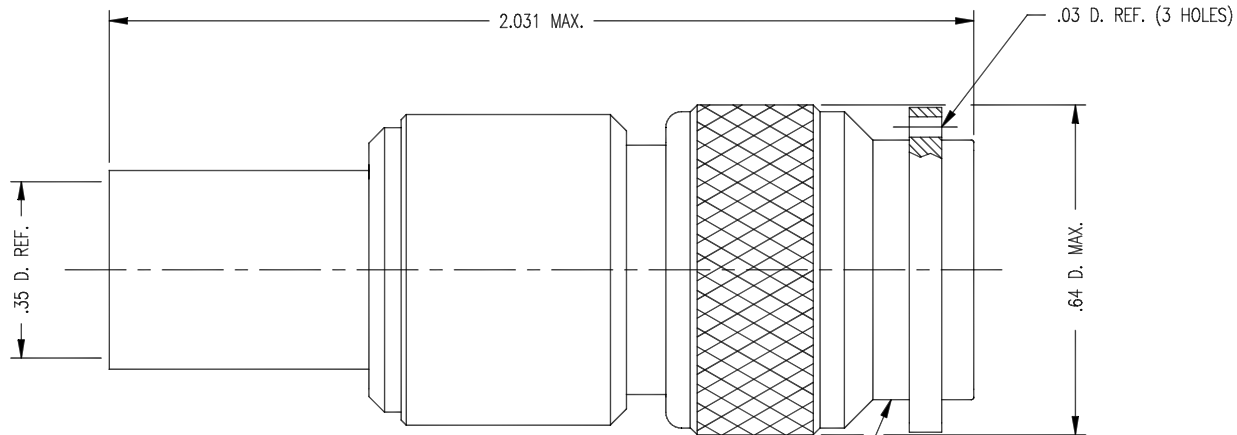

STAMP: KINGS 125-103-5

REVISIONS

ISSUE	CHANGES
0	ER 36808 KH 02/08/96
1	CN 39126 E JLA 08/04/04
C	REVISED PER ER18006 GGR 8/21/2009

KAM6383

THIS DRAWING, THE DESIGNS AND IDEAS EMBODIED IN THE DEVICE TO WHICH IT RELATES, AND THE METHOD OF PRODUCING THE DEVICE, ARE THE PROPERTY OF WINCHESTER ELECTRONICS CORPORATION AND SHALL NOT BE EMPLOYED, COPIED, OR DISCLOSED TO ANYONE, IN ANY MANNER WITHOUT THE CONSENT OF WINCHESTER ELECTRONICS CORPORATION.

SCALE 4:1

APPROX SURFACE AREA

WAS: E-19223

USED ON

REF: Mc D. D. AIRCRAFT # 5D0490-1 REV. E

PLUG, TNC

DRAWN KH DATE 02/08/96

DESIGN CT DATE 02/09/96

APPR. DATE



Winchester Electronics
82 Barnes Industrial
Road North
Wallingford, CT 06492

GSD

125-103-5

NOTES:

1. FOR USE WITH DOUGLAS D2348-2 CABLE.
2. FOR CABLING INSTRUCTIONS SEE CP-5402.
3. FOR CRIMPING USE DIE KTH-2012.
4. INTERFACE PER MIL-STD-348, FIG. 313-1.
5. CENTER CONTACT (1-761-21M9D) SUPPLIED UNASSEMBLED.
6. MARK PACKAGE: 91836

KINGS 125-103-5
YRWK (DATE CODE)
DOUGLAS 5D0490-1

7. MATERIALS:

- INSULATOR: TEFLON, ASTM-D-4894
- K-GRIP SLEEVE: COM. BRONZE, ASTM-B-135
- OUTER CONTACT: BER. COPPER, ASTM-B-196
- GASKET: SILICONE RUBBER, ZZ-R-765
- C-RING: PHOSPHOR BRONZE, ASTM-B-103
- ALL OTHER METAL PARTS: BRASS, ASTM-B16

8. FINISHES:

- CENTER CONTACT: GOLD PLATE, PER MIL-G-45204
- ALL OTHER METAL PARTS: SILVER PLATE PER QQ-S-365

9. ELECTRICAL CHARACTERISTICS:

- NOMINAL IMPEDANCE: 50 OHMS
- WORKING VOLTAGE: 500 VRMS
- FREQUENCY RANGE: DC TO 11 GHz